

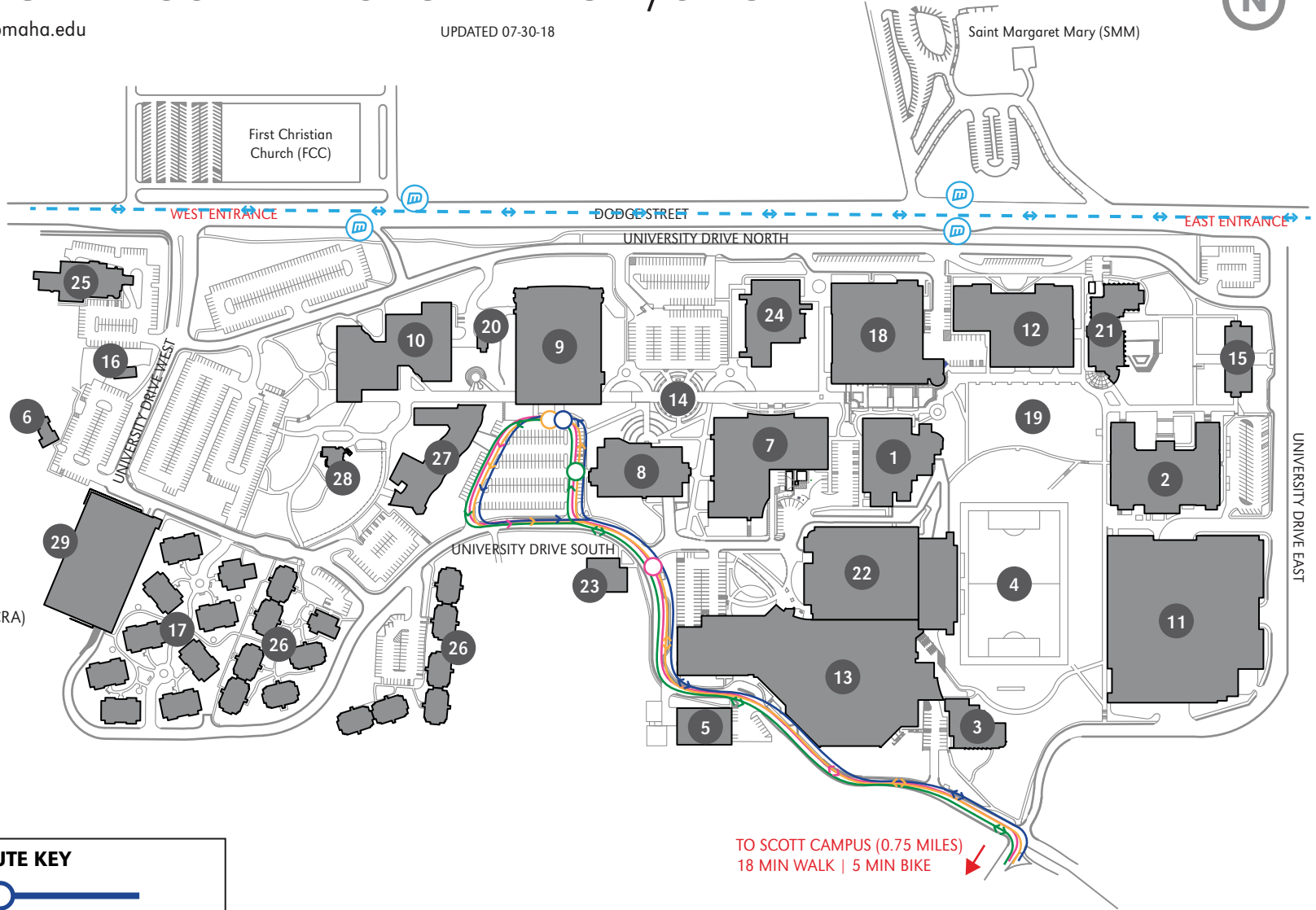

BUILDING KEY

- 1 Allwine Hall (AH)
- 2 Arts & Sciences Hall (ASH)
- 3 Biomechanics Research Building (BRB)
- 4 Caniglia Field (CF)
- 5 Central Utilities Plant (CUP)
- 6 Child Care Center (CCC)
- 7 College of Public Affairs & Community Service (CPACS)
- 8 Barbara Weitz Community Engagement Center (Weitz CEC)
- 9 Criss Library (CL)
- 10 Durham Science Center (DSC)
- 11 East Parking Garage (EPG)
 - Lot T - Lower Level
 - Lot U - Middle Level
 - Lot V - Upper Level
- 12 Eppley Administration Building (EAB)
- 13 Health & Kinesiology Building (H&K)
- 14 Henningson Memorial Campanile (HMC) (clock tower)
- 15 Kayser Hall (KH)
- 16 Landscape Services (LS)
- 17 Maverick Village (MV)
- 18 Milo Bail Student Center (MBSC)
- 19 Pep Bowl (open space)
- 20 Resource Conservation & Recovery Area (RCRA)
- 21 Roskens Hall (RH)
- 22 Sapp Fieldhouse (SFH)
- 23 Sculpture & Ceramics Studio (SCS)
- 24 Strauss Performing Arts Center (SPAC)
- 25 Thompson Alumni Center (TAC)
- 26 University Village (UV)
- 27 Weber Fine Arts Building (WFAB)
- 28 6533 University Drive South (WC)
- 29 West Parking Garage (WPG)



TRANSPORTATION/SHUTTLE ROUTE KEY

NEWMAN CENTER/DODGE SHUTTLE	MAMMEL/LIBRARY SHUTTLE
SCOTT RESIDENT EXPRESS SHUTTLE	METRO BUS ROUTE (2)
PACIFIC ST. GARAGE/LIBRARY SHUTTLE	



UNIVERSITY OF NEBRASKA AT OMAHA

SCOTT CAMPUS TRANSPORTATION/SHUTTLE MAP

402.554.2800 | unomaha.edu

UPDATED 07-30-18



TO DODGE CAMPUS (0.75 MILES)
18 MIN WALK | 5 MIN BIKE

PACIFIC STREET

72ND STREET

72ND STREET

PINE STREET

AKSARBE DRIVE

67TH STREET

SHIRLEY STREET

TO CENTER CAMPUS (0.70 MILES)
14 MIN WALK | 5 MIN BIKE

TRANSPORTATION/SHUTTLE ROUTE KEY



MAMMEL/LIBRARY SHUTTLE



METRO BUS ROUTE (2)



NEWMAN CENTER/DODGE SHUTTLE



SCOTT RESIDENT EXPRESS SHUTTLE



PACIFIC ST. GARAGE/LIBRARY SHUTTLE

BUILDING KEY

- A Peter Kiewit Institute (PKI)
- B Mammel Hall (MH)
- C Scott Residence Hall (SRH)
- D Scott Conference Center (SCC)
- E Scott Village (SV)
- F Scott Court (SC)
- G Scott Technology Center (STC)
- H Pacific Street Garage (PSG)
- I Parking Services (PS)
- J Newman Center (NC)
- K Maverick Landing/
Scott Crossing

UNIVERSITY OF
Nebraska
Omaha

THIS IS A SMOKE- AND TOBACCO-FREE CAMPUS AS OF 8/22/16



UNIVERSITY OF NEBRASKA AT OMAHA

CENTER CAMPUS TRANSPORTATION/SHUTTLE MAP

402.554.2800 | unomaha.edu

UPDATED 07-30-18

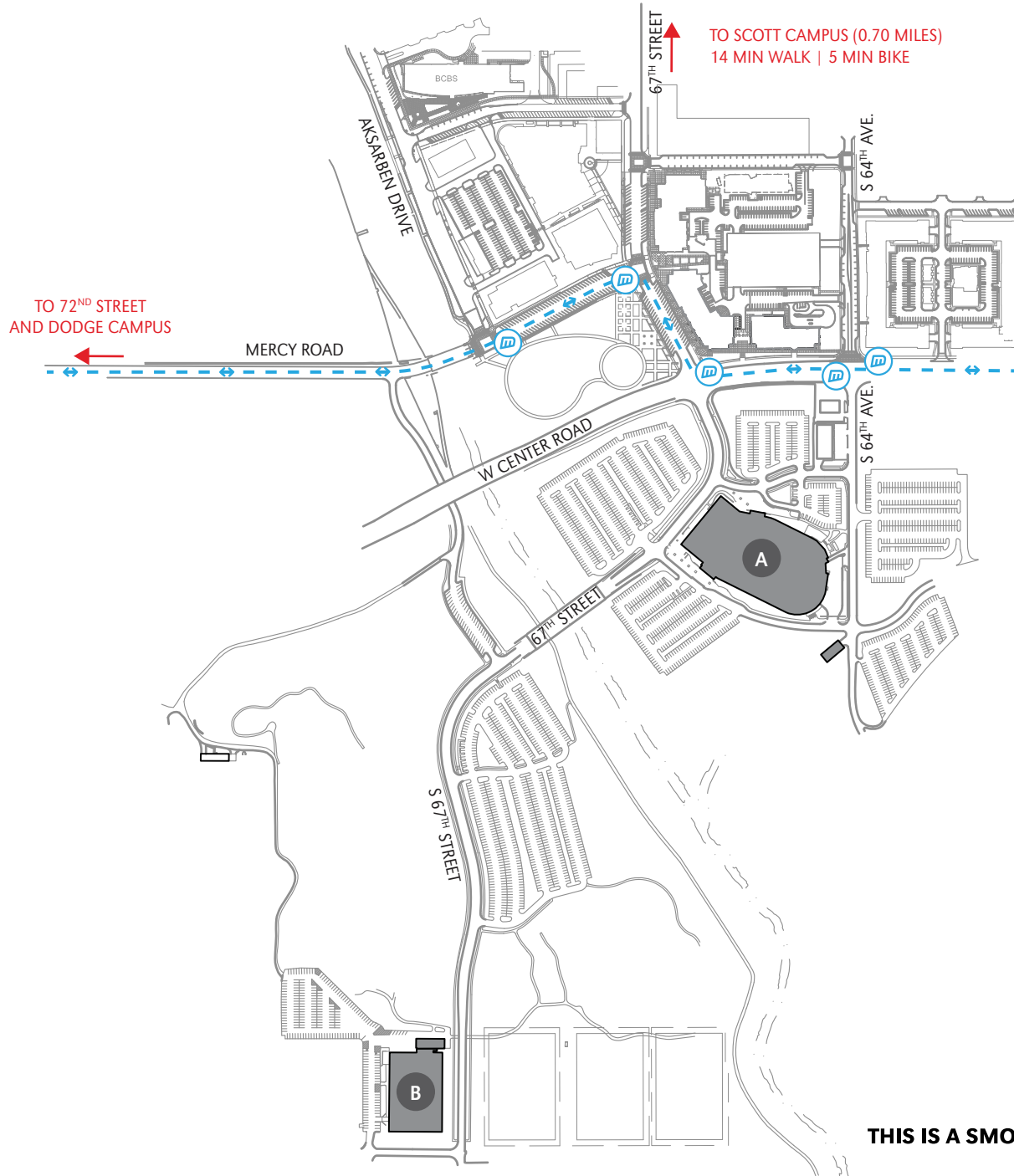

TRANSPORTATION/SHUTTLE ROUTE KEY

 METRO BUS ROUTE (15)

BUILDING KEY

- A Baxter Arena
- B Center Dome